

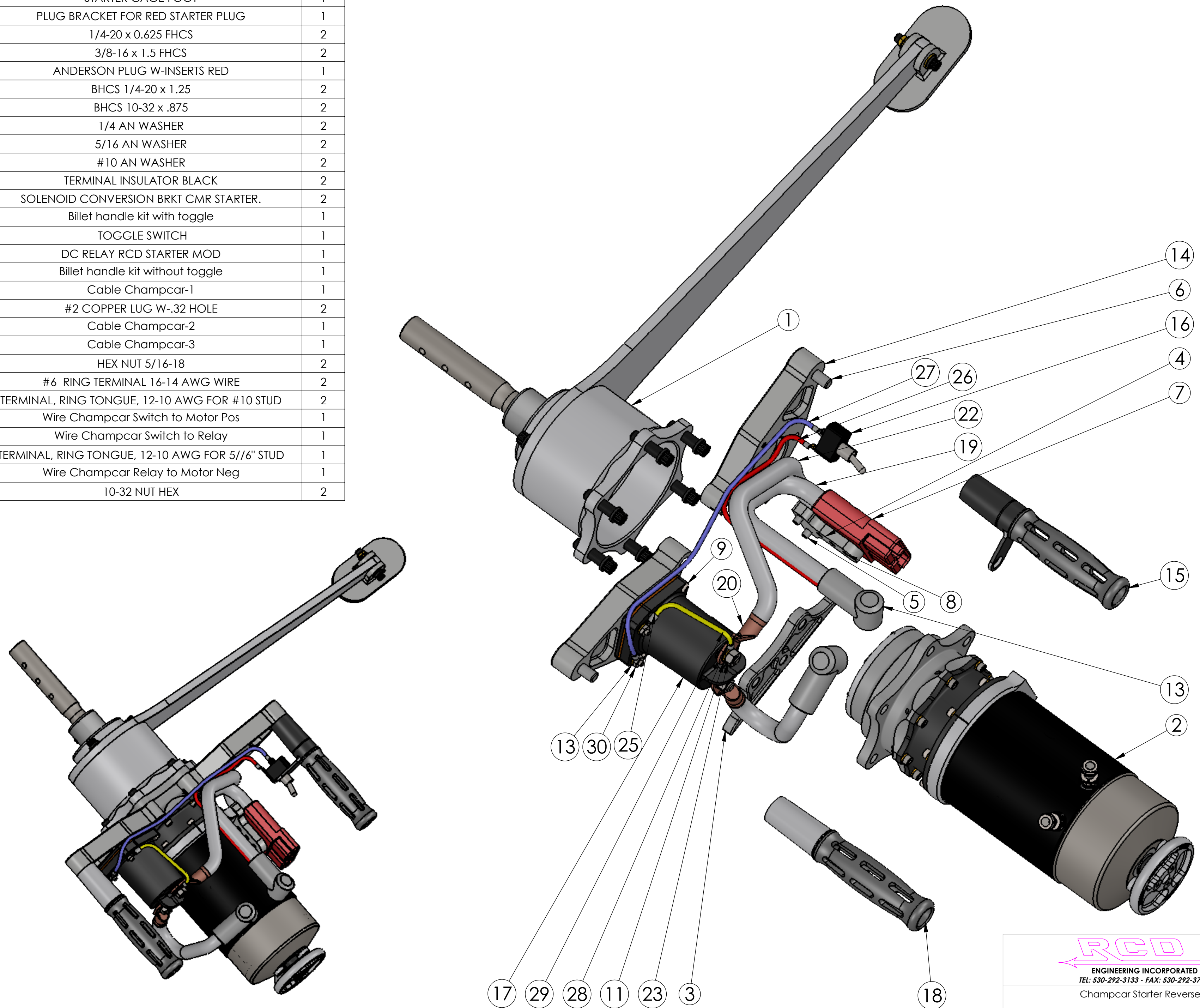

ITEM	PART NO.	DESCRIPTION	QTY.
1	102700-0011	CHAMP CAR NOSE HOUSING REV	1
2	101500-0086	STARTER W_HANDWHEEL 6IN-RCD GEARHEAD LH HD	1
3	102510-08	STARTER CAGE FOOT	1
4	102510-11	PLUG BRACKET FOR RED STARTER PLUG	1
5	356925-10SS	1/4-20 x 0.625 FHCS	2
6	356937-24	3/8-16 x 1.5 FHCS	2
7	103006-88	ANDERSON PLUG W-INSERTS RED	1
8	356625-20	BHCS 1/4-20 x 1.25	2
9	356510-14	BHCS 10-32 x .875	2
10	352503-04	1/4 AN WASHER	2
11	352503-05	5/16 AN WASHER	2
13	352503-03	#10 AN WASHER	2
13	101513-51	TERMINAL INSULATOR BLACK	2
14	102510-18	SOLENOID CONVERSION BRKT CMR STARTER.	2
15	102505-0022	Billet handle kit with toggle	1
16	102505-10	TOGGLE SWITCH	1
17	102505-18	DC RELAY RCD STARTER MOD	1
18	102510-0024	Billet handle kit without toggle	1
19	111	Cable Champcar-1	1
20	101513-02	#2 COPPER LUG W-.32 HOLE	2
21	111	Cable Champcar-2	1
22	111	Cable Champcar-3	1
23	355131-60	HEX NUT 5/16-18	2
24	102505-20	#6 RING TERMINAL 16-14 AWG WIRE	2
25		TERMINAL, RING TONGUE, 12-10 AWG FOR #10 STUD	2
26	111	Wire Champcar Switch to Motor Pos	1
27	111	Wire Champcar Switch to Relay	1
28		TERMINAL, RING TONGUE, 12-10 AWG FOR 5/16" STUD	1
29	111	Wire Champcar Relay to Motor Neg	1
30	355110-10	10-32 NUT HEX	2



ENGINEERING INCORPORATED
 TEL: 530-292-3133 - FAX: 530-292-3738
 Champcar Starter Reverse